

borg & overström B3



Dispense Options



Chilled



Ambient



Hot



Sparkling

Contents

Component/Feature Overview

Operation

Functions & Controls

General Safety

CO2 Bottle Installation

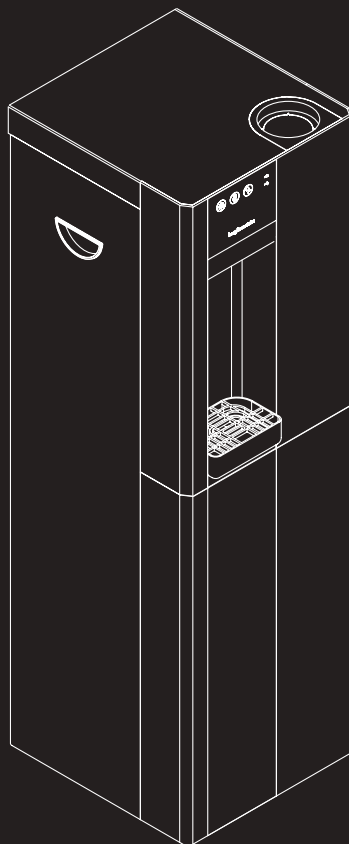

Component/ Feature Overview

B3 - Major Components

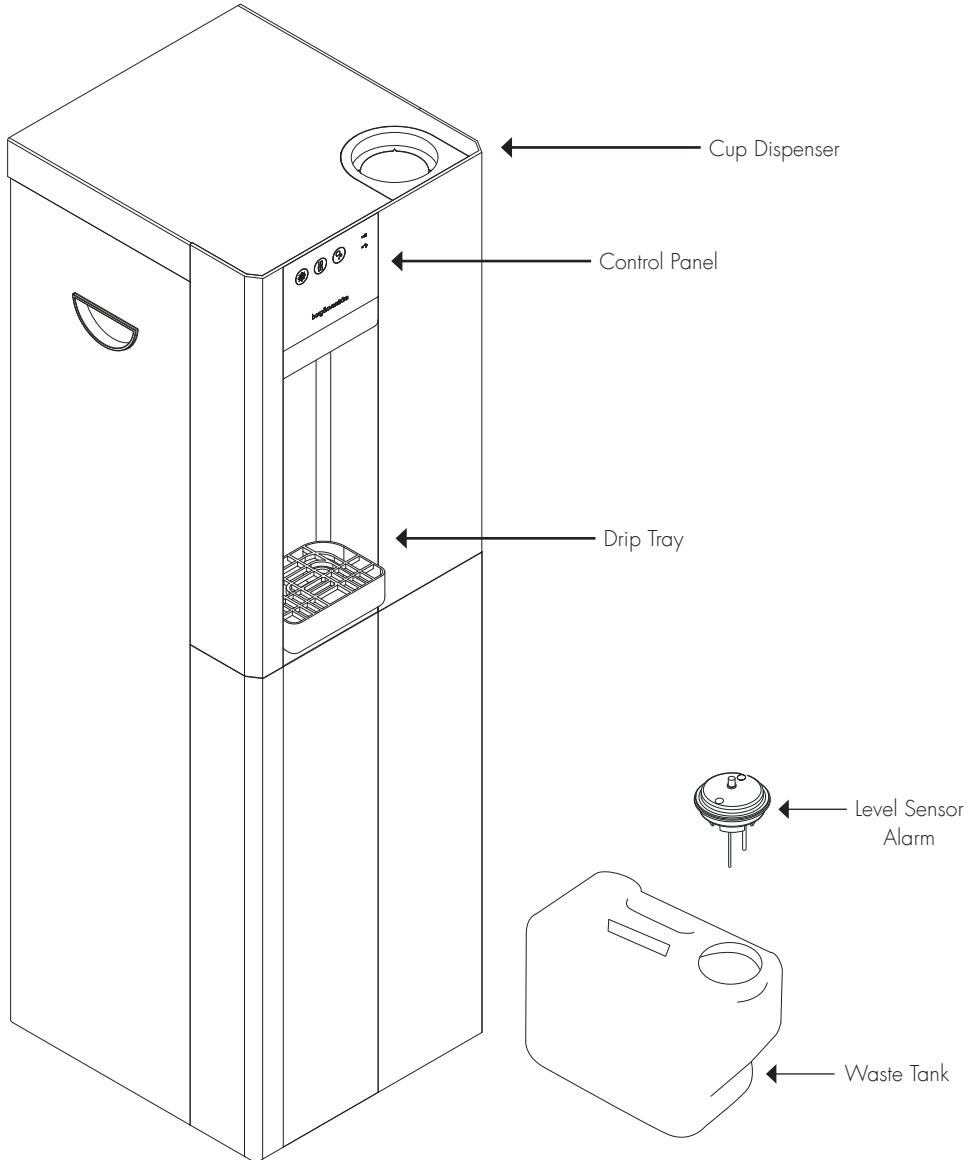

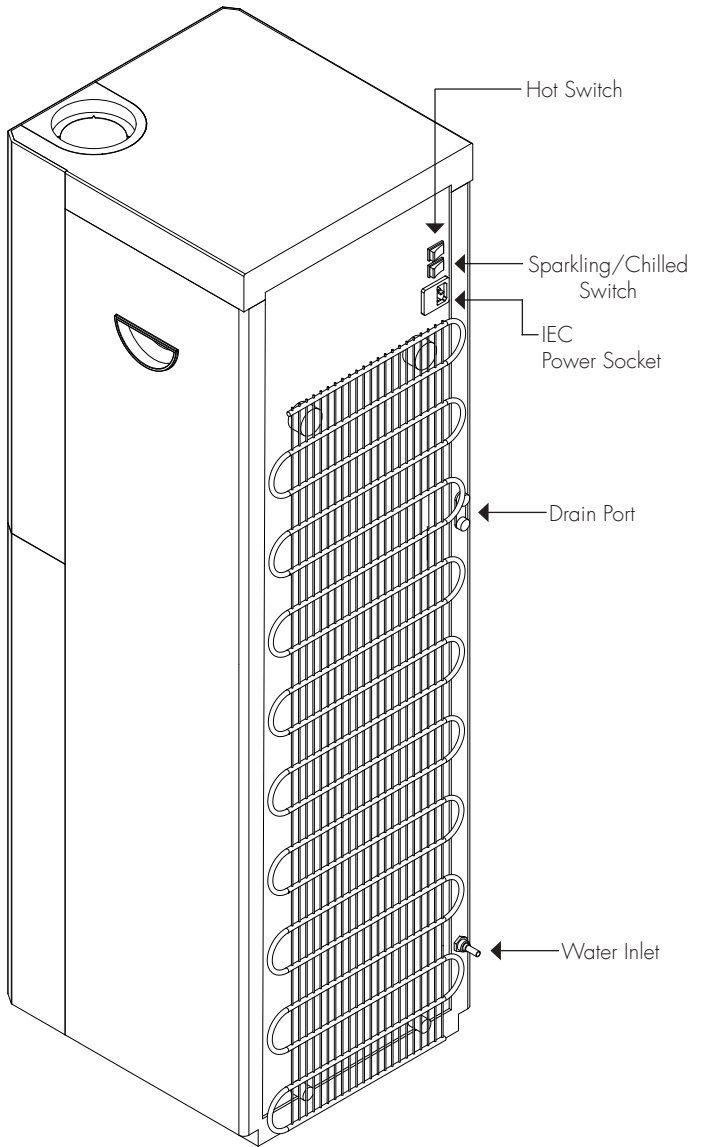
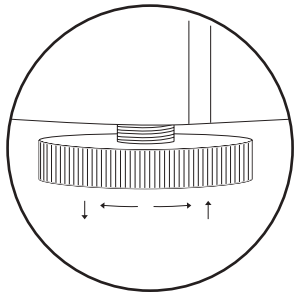
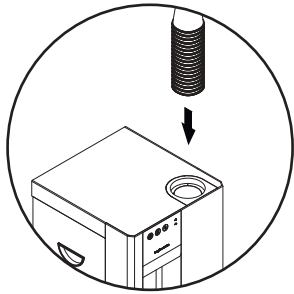

Operation

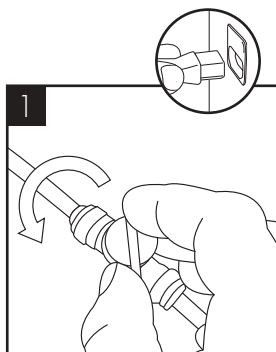

1
Connect and turn on the water supply. Then connect the power supply.

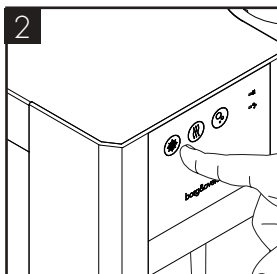

2
All hot & non sparkling cold tanks must be purged of air by holding the corresponding button.

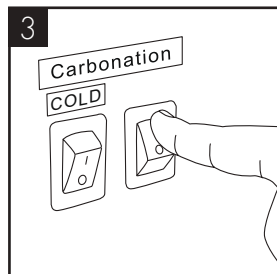

3
On sparkling models turn on the carbonation switch on the back of the unit.

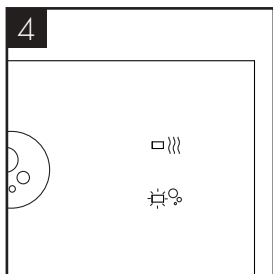

4
The relevant indicator lights will be lit.

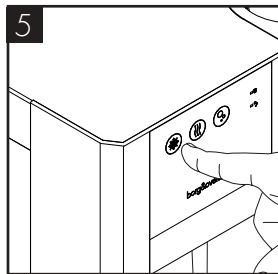

5
Press and hold the cold water button until water comes out.

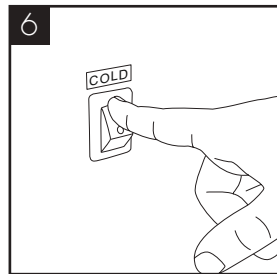

6
To avoid damage do not turn on the cold power switch until water flows out of the machine.

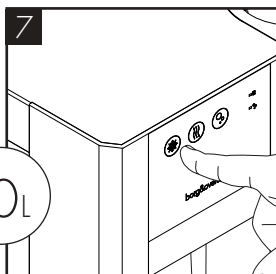

7
Flush through 10 litres of water before use.

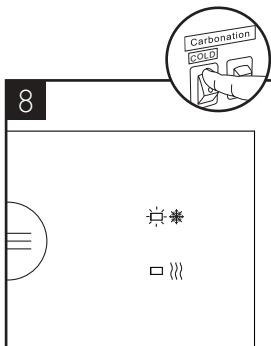

8
When the cold water switch is turned on, the cold water and indicator will be lit.

Functions & Controls

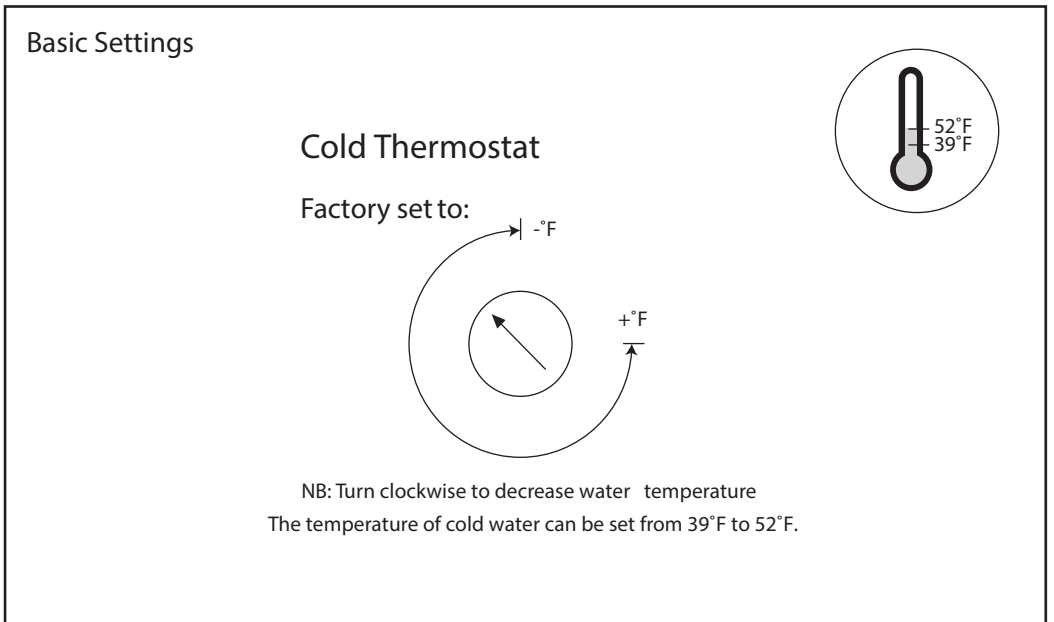
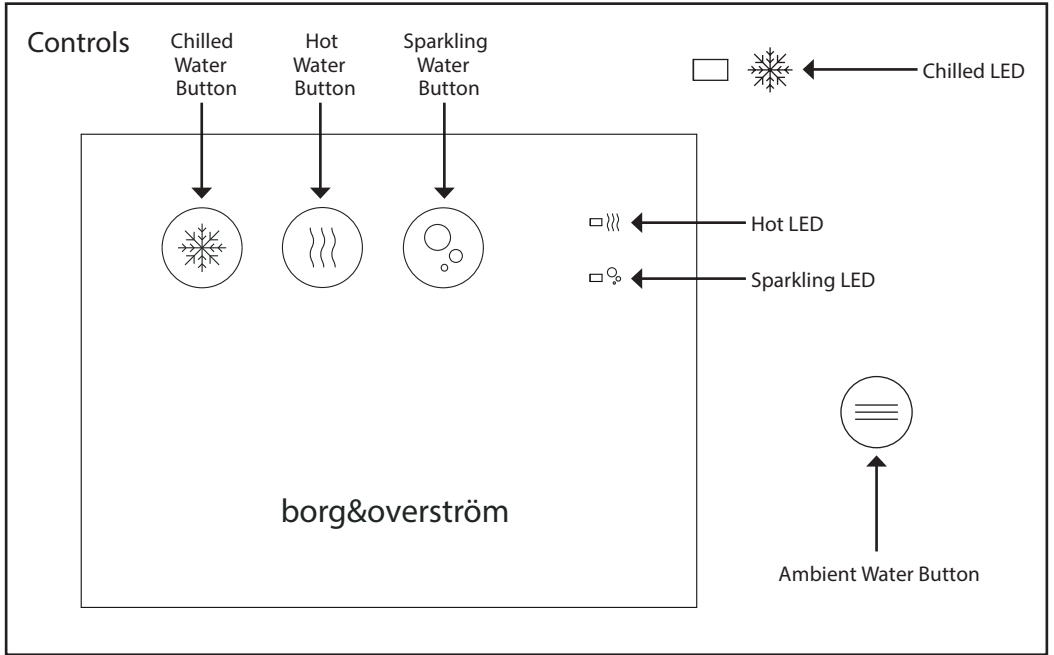

General Safety

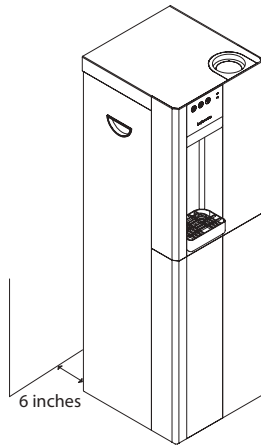

- Leave a space no less than 6 inches between the wall and dispenser.
- Keep the machine away from sunlight, heat and moisture.



Basic Troubleshooting		
Problem/Report	Possible Cause	Suggested Action
No Water Dispensing	Water supply turned off.	Check that power supply, and all taps/ valves/ filters on the incoming water supply are fitted and are turned on.
	"Leak detector" (if fitted) tripped off.	Disconnect the power and water supply, check for leaks. To reset the machine contact your distributor.
	Faulty water pressure regulator, or other failure.	Contact your distributor.
No/Low Sparkling Water	No/incorrect CO2 pressure	Check CO2 bottle, regulator and non-return valve. Replace as necessary.
	Carbonator tank not filling	Contact your distributor.
Warm Drinks	Insufficient cooling air flow through the fridge.	Contact your distributor.
	Faulty compressor, or other failure.	
Water lying on top edge of lower door panel and/or bottom of cabinet.	Overflowing drip tray waste container.	Empty waste container and check drainpipe is not blocked.
Water lying in bottom of machine.	Leak in pipe work and/ or filter.	Contact your distributor.
Bleeping Noise	Level sensor fitted and tank full.	Empty level sensor tank.

CO2 Bottle Installation - Sparkling Versions Only

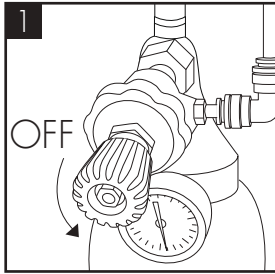

Attach the regulator to the disposable CO2 bottle, ensuring the regulator is closed.

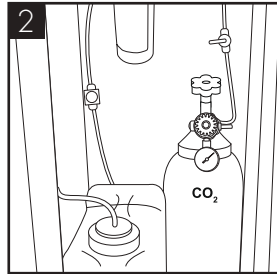

Connect the assembled CO2 bottle and regulator to the machine using 1/4 inch pipe.

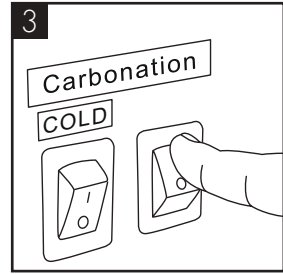

After completing the water installation, turn on the sparkling power switch and the pump will run. Do not open the regulator valve until the carbonated switch has been turned on.

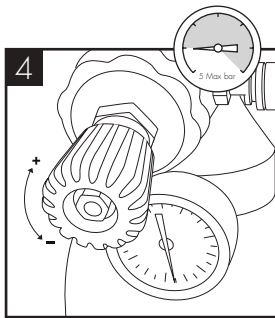

We recommend between 3.5 - 5 bar. Do not exceed 5 bar pressure.

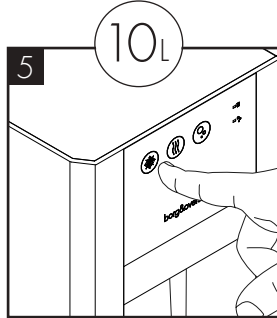

Flush through approximately 10 litres of water. Check and adjust the CO2 pressure accordingly.

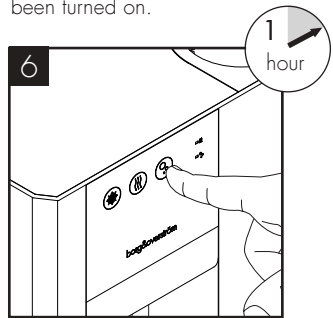

It will be necessary to leave the machine for up to 1 hour for sparkling water to develop, by absorbing the CO2.



For full distributor
service manual visit:

www.youraquaessentials.com

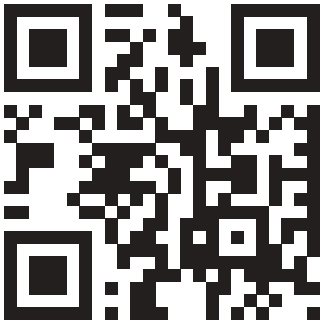

Customer services:

Email: rmiller@youraquaessentials.com

Call: 1 (615) 942-7867

Fax: 1 (615) 345-0500

Telephone
(615) 942-7867

Email
rmiller@youraquaessentials.com

www.youraquaessentials.com

Aqua Essentials
1416 Antioch Pike, Suite 103
Nashville, TN 37013

Verson : 121718 -01